



UNISINOS

Somos infinitas posibilidades



CHIP

Instituto Tecnológico
de Semicondutores



CHIP

Instituto Tecnológico
de Semicondutores







itt Chip – Cleanroom – Structure

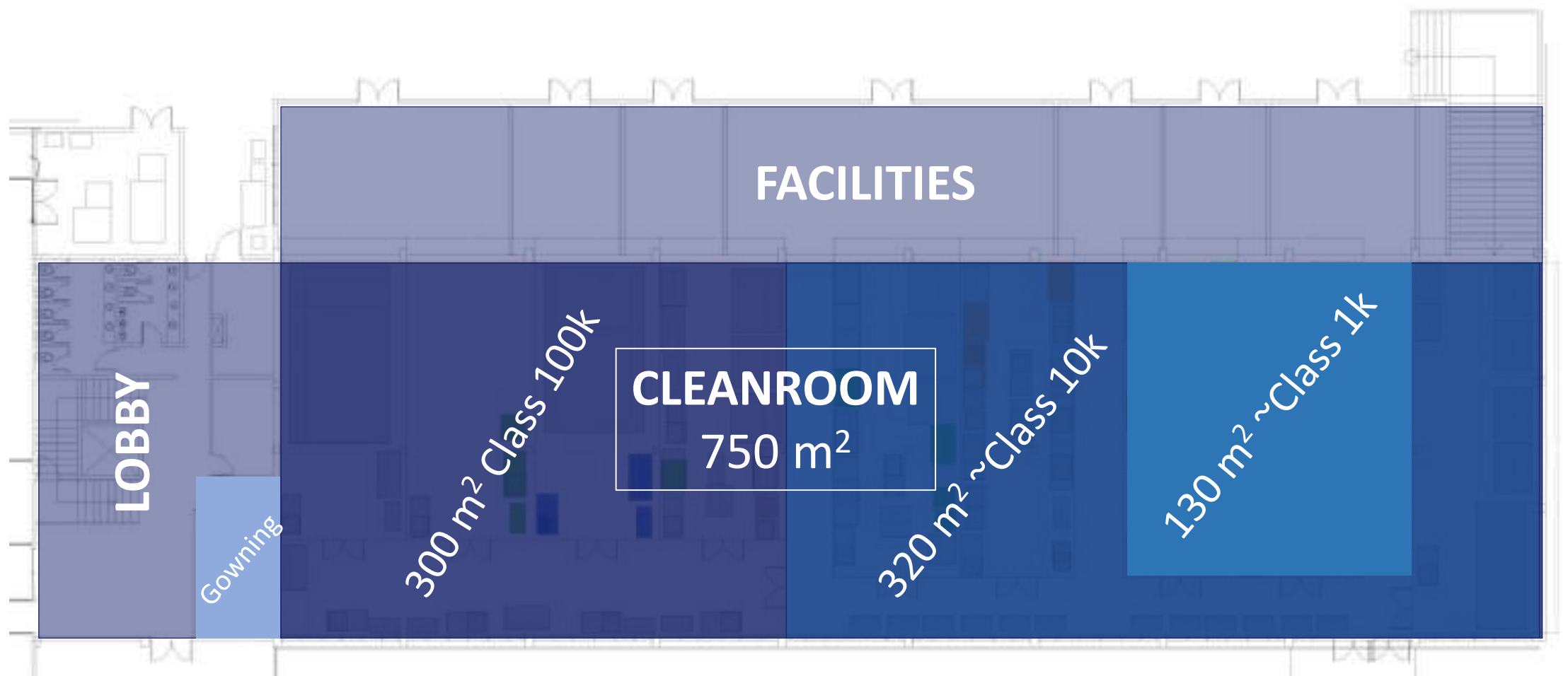

CLEANROOM LABs



itt Chip – Cleanroom – Localization

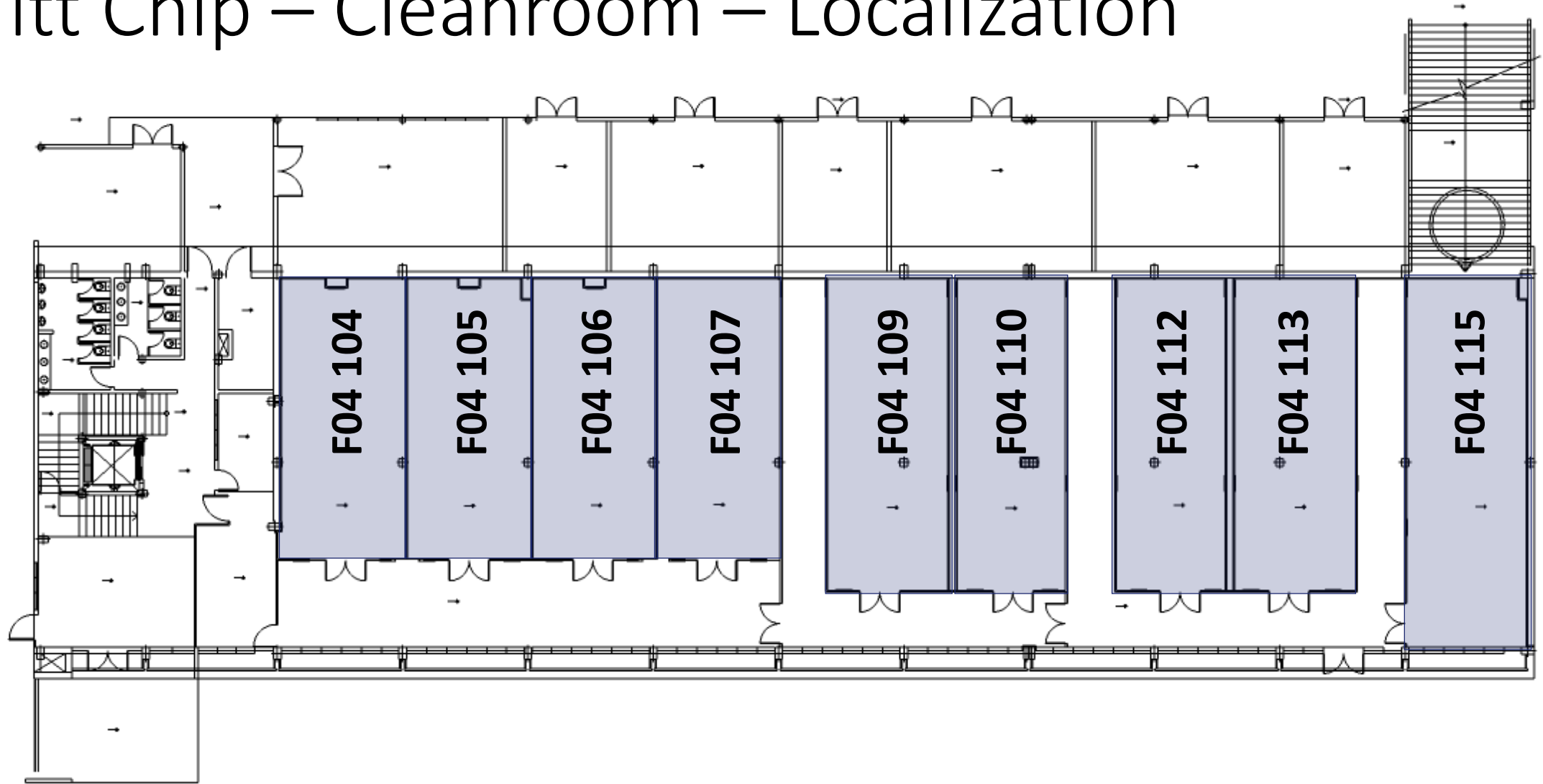

itt Chip – Cleanroom – Labs

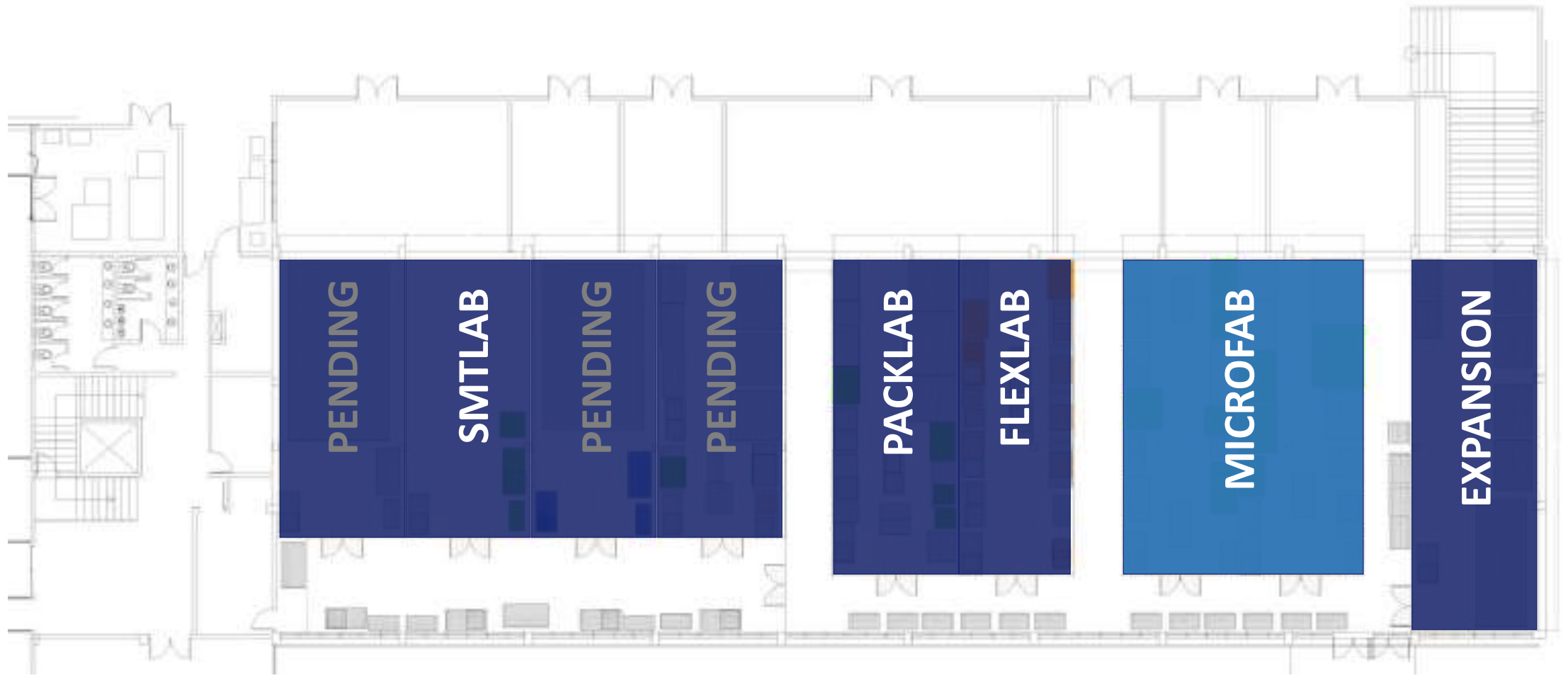

LABS PENDING... INFRASTRUCTURE READY

F04 104, F04 106 AND F04 107



SMT PROTOTYPING LAB

SMTLAB

F04 105



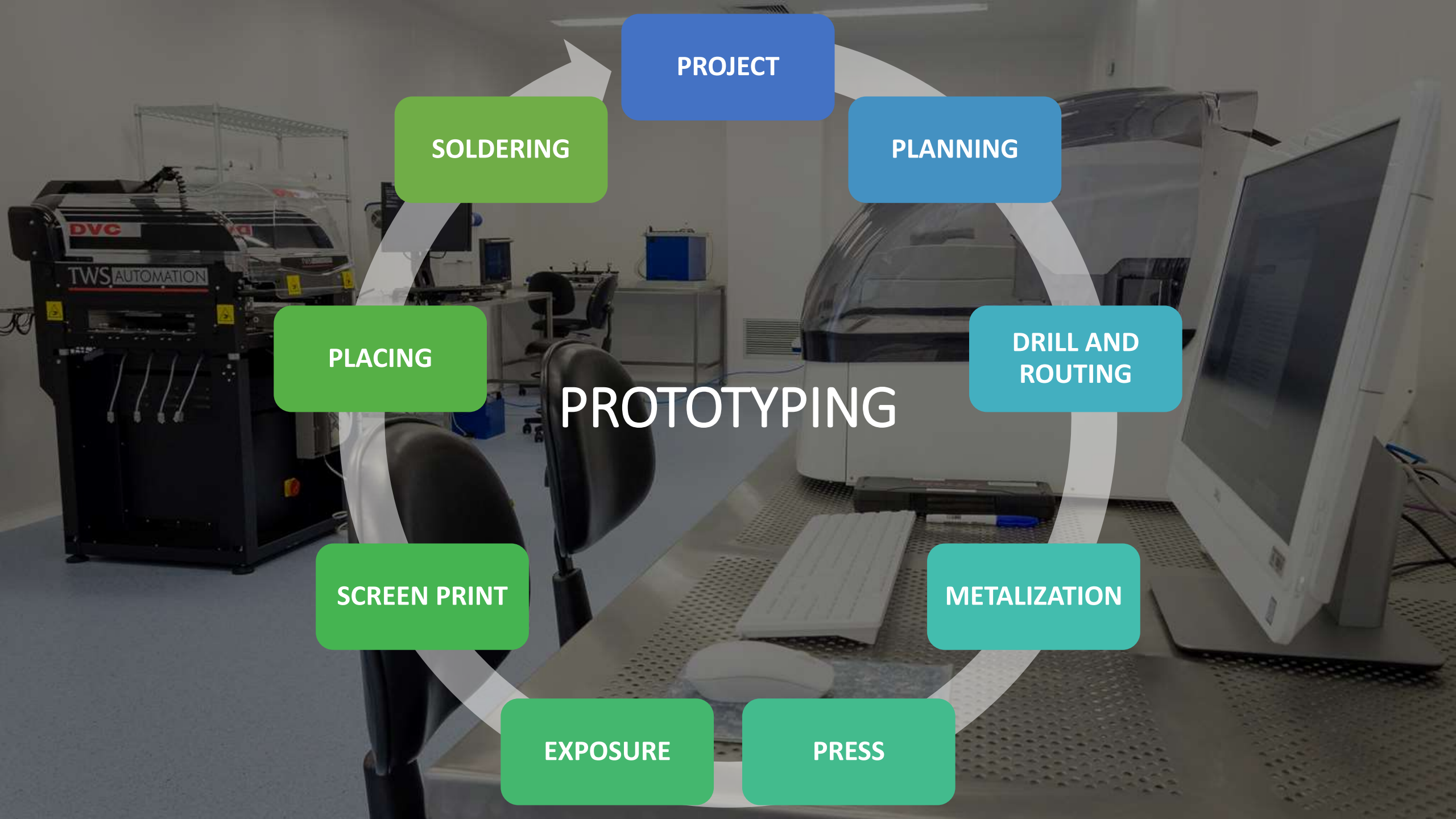

PROJECT

SOLDERING

PLANNING

PLACING

DRILL AND
ROUTING

PROTOTYPING

SCREEN PRINT

METALIZATION

EXPOSURE

PRESS

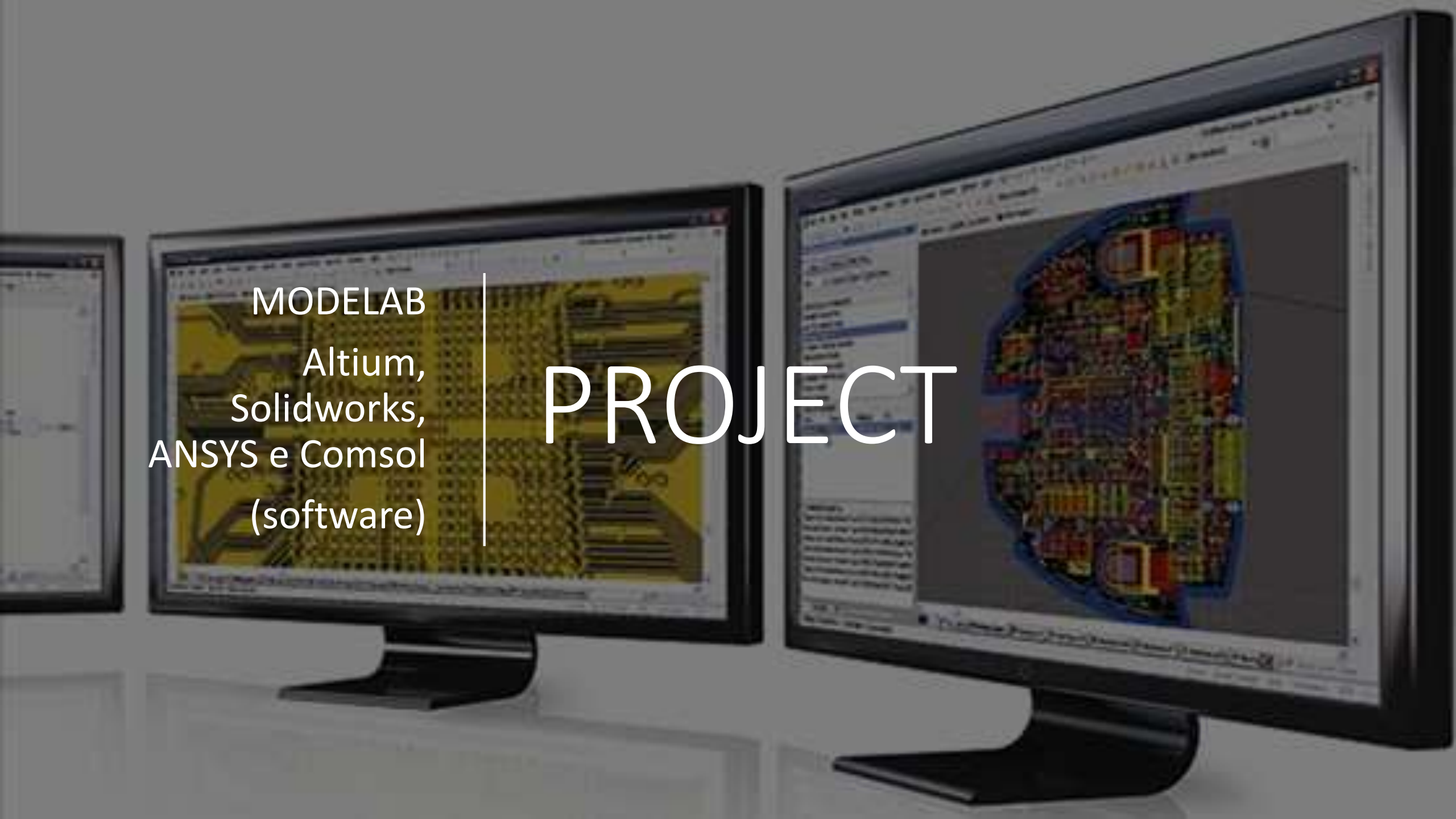

MODELAB
Altium,
Solidworks,
ANSYS e Comsol
(software)

PROJECT

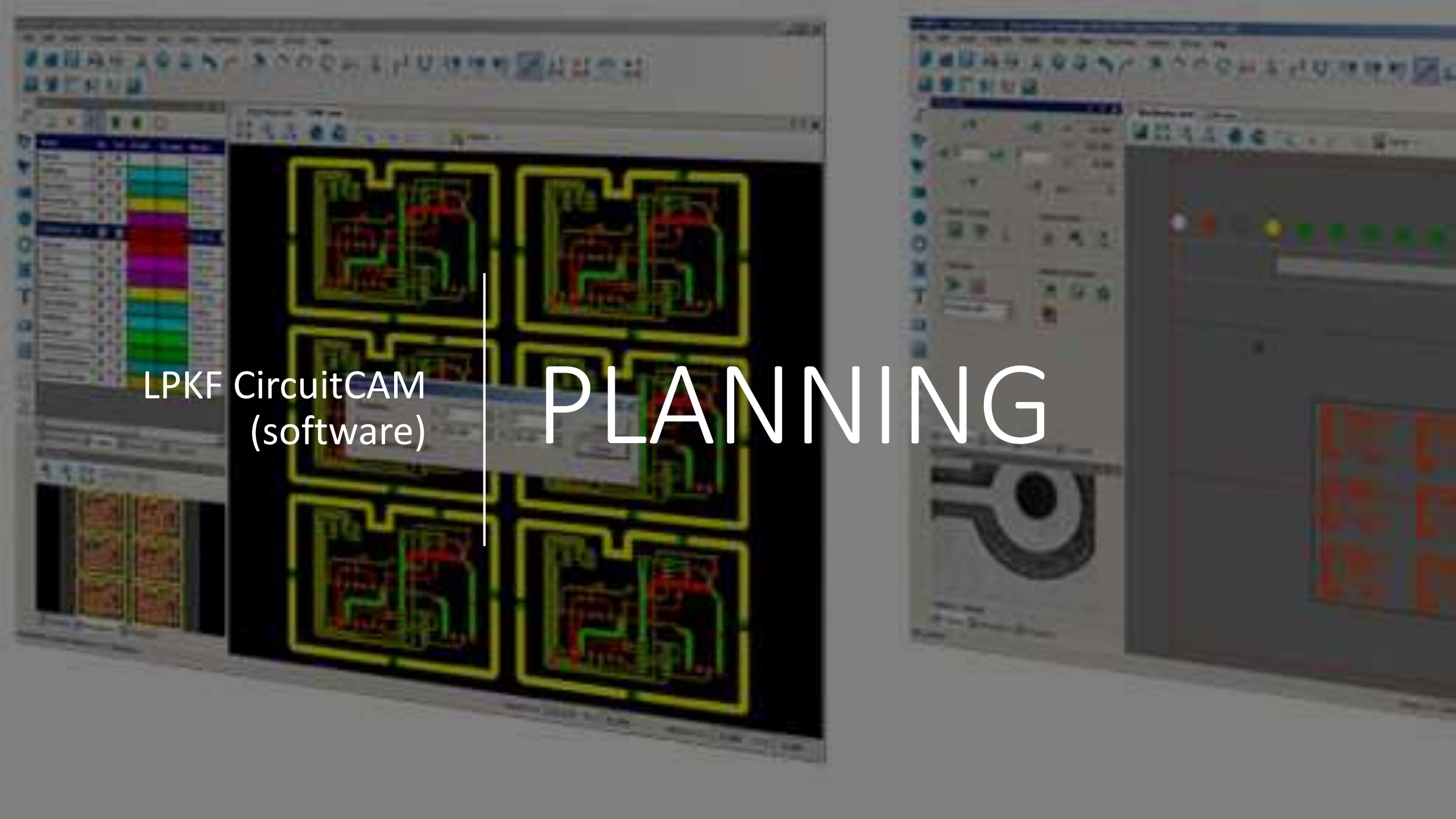
The image shows a screenshot of the LPKF CircuitCAM software interface. The central focus is a 2x2 grid of PCB layout designs, each enclosed in a yellow border. The designs feature green and red traces on a dark background. To the left of the grid is a vertical toolbar with various icons, and below it is a data table with multiple columns and rows of colored cells. On the right side, there are several panels, including a large one with a 3D-like view of a PCB and another with a circular graphic. The overall interface is typical of a CAD or CAM application.

LPKF CircuitCAM
(software)

PLANNING

LPKF ProtoMat
D104

DRILL AND ROUTING

LPKF ProtoMat

LPKF
Laser & Electronics

LPKF MiniContact
RS

METALIZATION



MultiPress S

LPKF MultiPress S

PRESS

LPKF
Laser & Electronics
www.lpkf.com

60W UV LAMPS

EXPOSURE

LPKF
Laser & Electronics



LPKF ProtoPrint S
(ZelFlex QR -
poliimida)

NORDSON EV3
(with EFD 794)

SCREEN PRINT

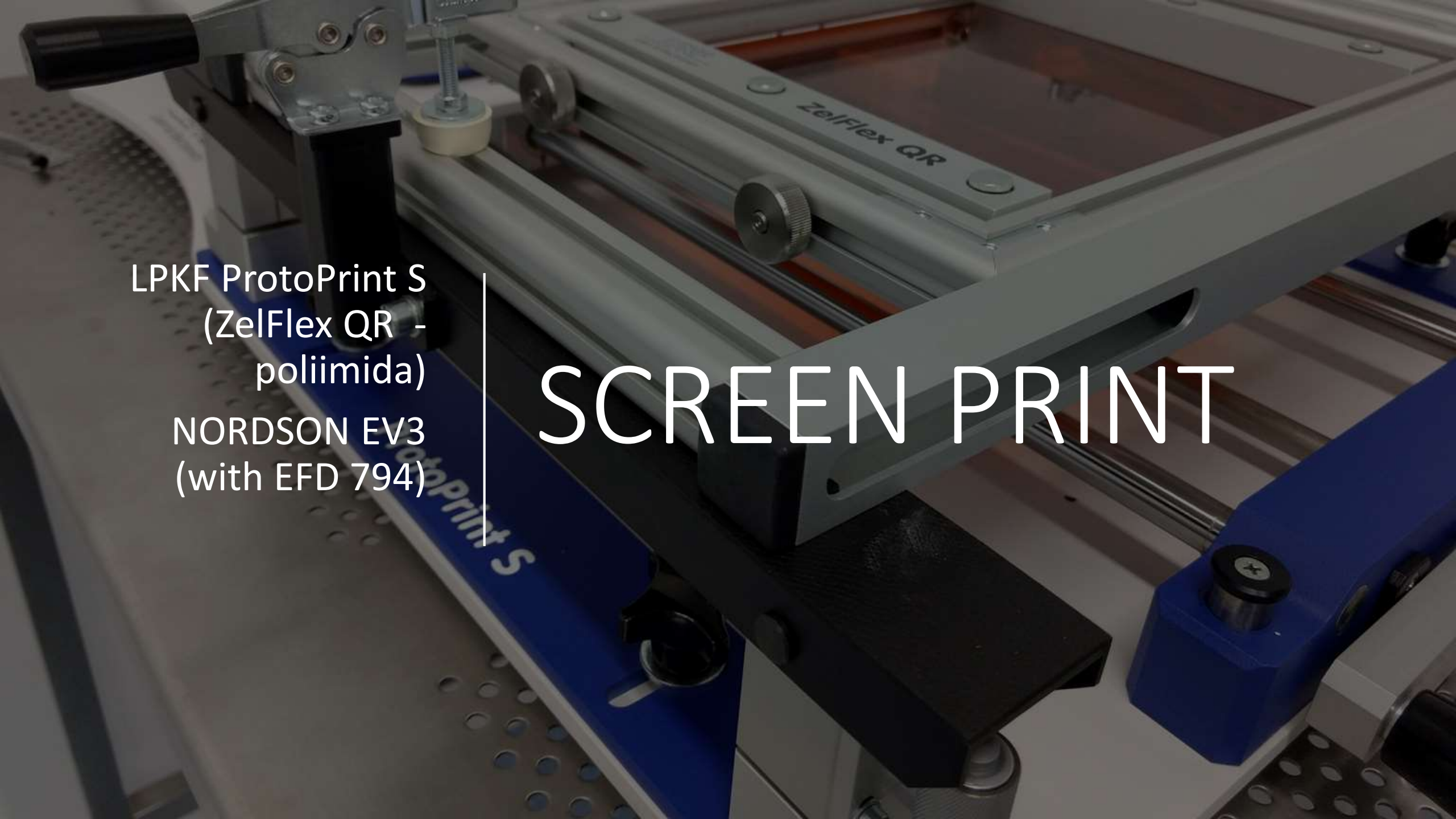

TWS Automation
– DVC EVO

PLACING

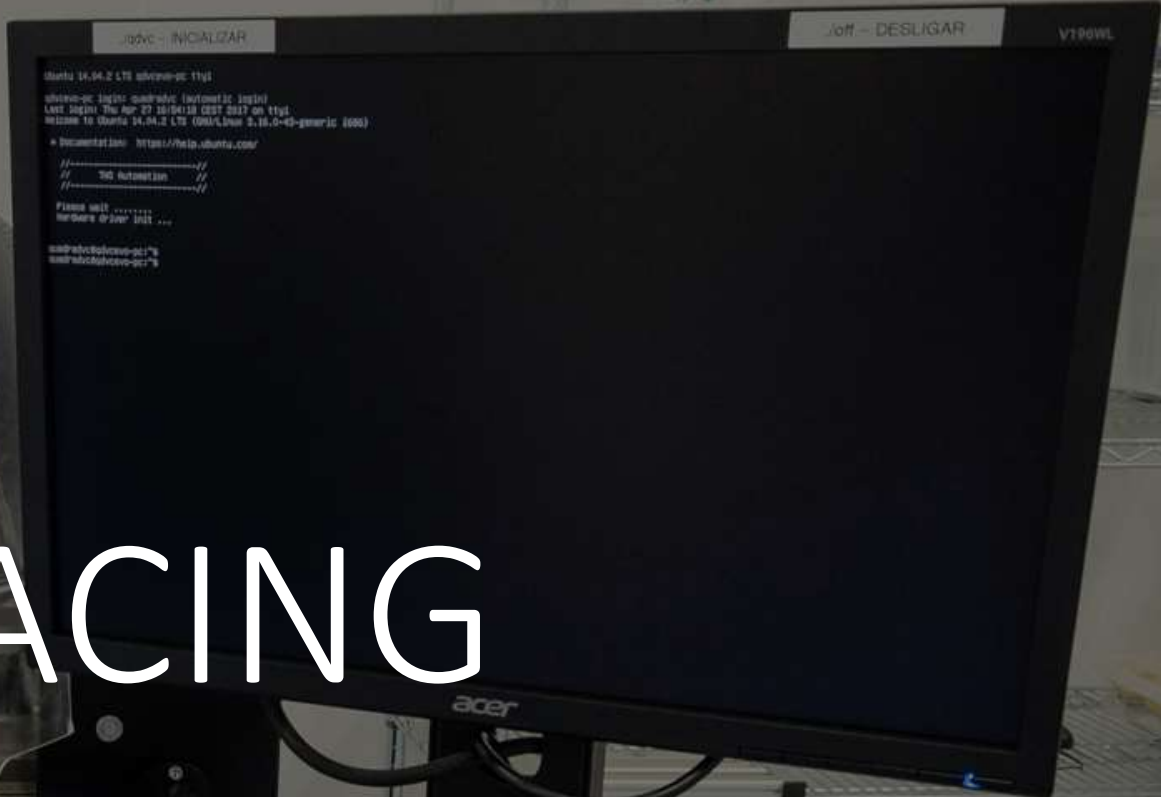

ProtoFlow S

LPKF ProtoFlow S

SOLDERING



LPKF
Laser & Electronics

DDM Novastar
GF-125 HC/HT

SOLDERING 5 ZONES



PACKAGING LAB

PACKLAB

F04 109



TPT
HB16

WIRED BONDER

tpt HB16

PLASMAETCH
PE-200 600W

PLASMA CLEANER

INSTALLATION PLANNED
TO JANUARY 2018

NORDSON
EV SERIES

DISPENSER





GRAPHTEC CUTTING PLOTTER CE6000-40

GRAPHTEC
CE-6000-40

CUTTER PLOTTER

A photograph of a Sunstone DC welder and micro-weld head setup. The welder is a black rectangular unit on the right, with the Sunstone logo on the front. The micro-weld head is a black robotic arm on the left, mounted on a metal table. The background is a plain white wall.

SUNSTONE
DC WELDER
AND WH2125A

LINEAR DC WELDER AND MICRO-WELD HEAD



ZEISS
STEMI 508

STEREO MICROSCOPE

FLEXIBLE ELECTRONICS LAB

FLEXLAB

F04 110







A photograph of a computer workstation on a desk. On the left is a white inkjet printer with a transparent front panel. In the center is a black monitor on a stand, with a black keyboard and mouse in front of it. On the right is a black tower PC. The background is a plain wall and a window on the left. The text 'DIMATIX DMP-2831' is overlaid on the printer, and 'INK JET PRINTER' is overlaid across the center of the image.

DIMATIX
DMP-2831

INK JET PRINTER



SIGNATONE
PRO4-4000

4-POINT PROBE



HITACHI
CF15RN
himac

HIGH-SPEED CENTRIFUGE



KLA-TENCOR
D-500

PROFILOMETER

AUTOLAB
PG-302N

POTENCIOSTAT GALVANOSTAT



ETHIK
400-3ND

OVEN

ethiktechnology



ESTUFA

01

ZEISS
AXIOLAB
A1 (MAT)

MICROSCOPE



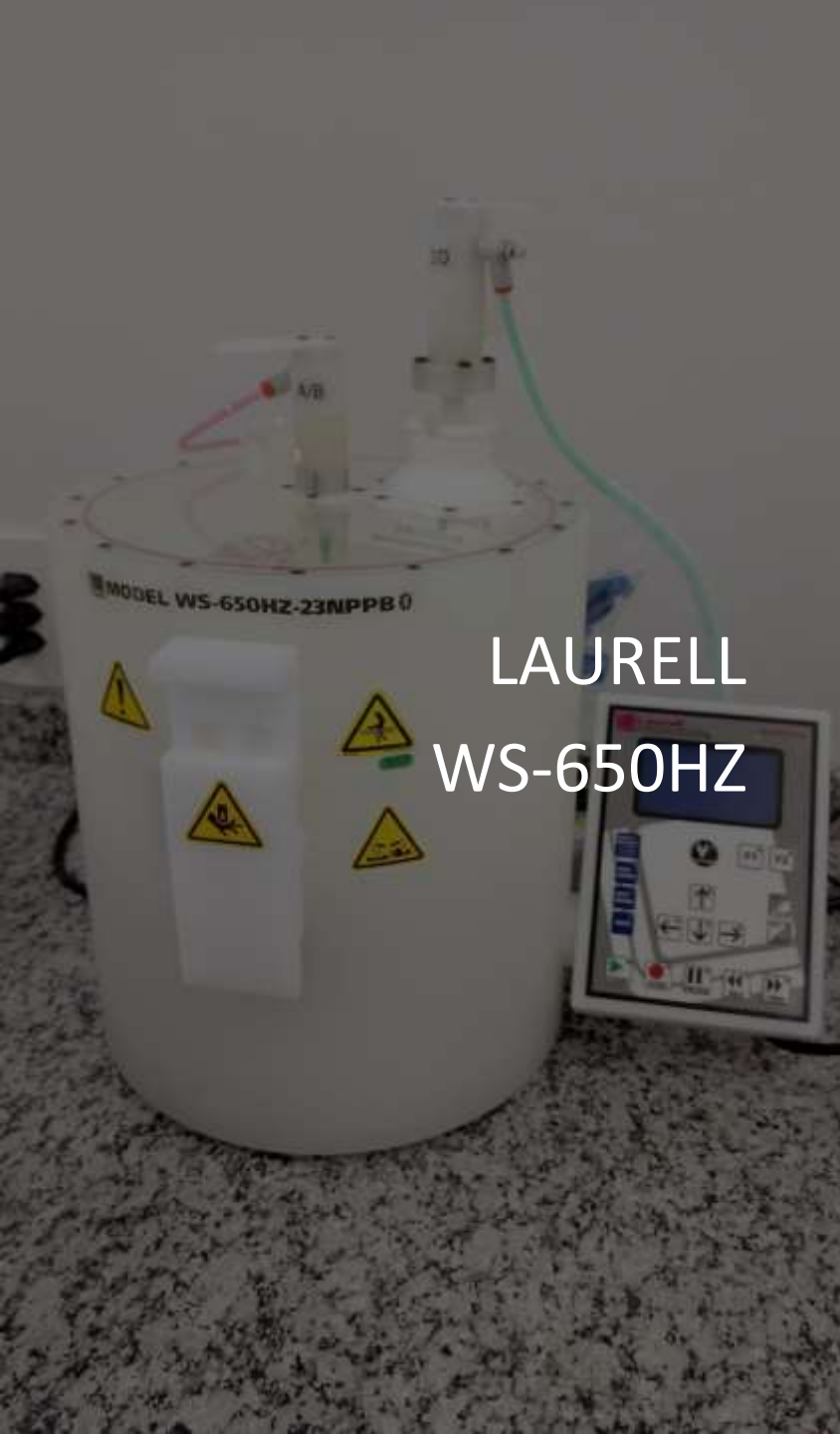

LAURELL
WS-650HZ

SPIN COATER

JUST RECEIVED...
BEING INSTALLED

The image shows two analytical balances on a speckled lab bench. On the left is a Sartorius balance with a large glass draft shield. On the right is a Shimadzu balance with a flat weighing pan. A power outlet is visible on the wall behind the balances. The text 'ANALYTICAL (AND SEMI) BALANCE' is overlaid in the center, and 'SARTORIUS SHIMADZU' is overlaid on the left side.

SARTORIUS
SHIMADZU

ANALYTICAL (AND SEMI) BALANCE

ULTRASONIC
BATH

PHMETER

MAGNETIC
STEERER

VORTEX
AGITATION

SOME EQUIP.
FOR CHEMICALS





PRODULAB

CHEMICAL HOOD

MICROFABRICATION LAB

MICROFAB

F04 112 AND F04 113

F04 112



F04 113



EXPANSION

F04 115



FACILITIES

JUST A FEW PICS



SAID

VORTX

Carrier





Carrier



AT LEAST SUNSET IS NICE...

